



Powerscreen of California
10 Case Court
American Canyon, CA 94503
Tel: (707) 253-1874
Fax: (707) 253-1874
Email: sales@powerscreen-norcal.com

INTRODUCING THE T5036 CONVEYOR



All specifications subject to change without prior notice.

FEATURES

- Total weight (Estimate) 4200kg (4.63 US Tonnes) (Diesel)
- Width (transport) 2.5m (8'3")
- Length (transport not folded) 15.6m (51'2")
- Length (transport folded) 11.3m (37'1")
- Height (stockpiling) 6.72m (22')
- Powerunit 4 cylinder Diesel engine 37kW (50 Hp)

ADVANTAGES

- Capable of handling up to 250TPH (780 U.S.).
- Quick set up time typically under 5 minutes.
- Mobile unit with towbar and road wheels.
- High performance hydraulic system.

APPLICATIONS

- Sand and gravel
- Topsoil
- Coal
- Crushed stone

The T5036 is a mobile, radial loading, high capacity stockpiling conveyor, which is strong and economical to run. The stockpiler is an integral part of the Powerscreen system and is constructed to the same high engineering specification.

The T5036 is versatile and can be self powered or coupled with a range of Powerscreen screening plants.

Its portability allows it to work in confined spaces and also where heavier conveyors would find it impossible to maneuver.

The T5036 consists of a pivot stand, feedboot, conveyor, radial wheels and has optional hydraulic or electric drives.

Pivot Stand:

This is attached to the main frame directly below the feedboot, is height adjustable, and supports the conveyor at the feed end. The conveyor swivels from this center point when the conveyor is moved through an arc.

Technical Specification



T6532 24-01-2007

Page 3

Feedboot:

The feedboot directs the sand, gravel, coal etc. onto the conveyor belt.

Conveyor:

The main frame can be raised or lowered with a hydraulic cylinder giving alternate stockpiling heights. The conveyor belt can be either plain or chevron, 2 ply, 900mm (36") wide.

Radial Wheels:

The conveyor is mounted on two swiveling wheels to give radial stockpiling through an arc of approximately 180 degrees.

Drive:

- a) Self contained 58 H.P. diesel engine.
- b) Electric motor 50 H.P.
- c) T5036 conveyors can be coupled easily from other Powerscreen machines.

Overall Dimensions:

Maximum Stockpiling Height: 6.9m

Stockpile Capacity: Static 280cu m (365 cu yard)

Radial (60° Arc) 980cu m (1280 cu yard)

Tyre Size: 10.0/75-15.3 x 10 Ply

Tyre Pressure: 4 Bar (60 PSI)

Wheel Stud Torque: 340 Nm (250-lbs. ft)

Technical Specification



Page 4

T6532 24-01-2007

DIESEL / HYDRAULIC DRIVE

Engine:

4 cylinder Tier 2 engine running at 2300 RPM developing 37 kW (50 HP)

HYDRAULICS

Hydraulic Pumps:

2PL105 giving a flow rate of 64 litres (14 gals) per minute.

Hydraulic Motor:

Diesel / Hydraulic power unit with a flow rate of 101 litres (22 gals) per minute: -
OMV 630

Control Valve:

Set at 200 Bar (2800 PSI)

Recommended Hydraulic Oil

0 Deg. C - 30 Deg. C ambient temp, shall Tellus 37 (or equivalent)
+ 30 Deg. C ambient temp, Shell Tellus 100 (or equivalent)

Hydraulic System Capacity:

183 litres (40 gals)

Typical Operating Pressures for 41 litres (9 Gals) Per Min System:

Empty: -	35 Bar (500 PSI)
250TPH (780 U.S.) per hour: -	160 Bar (2250 PSI)
Increase in pressure per 100 Tonnes (112 U.S. Tons) per hour: -	18 Bar (250 PSI)

Electric Drive

37 kW (50 HP) Electric Motor

Technical Specification



Page 5

T6532 24-01-2007

CONVEYOR DETAILS

Conveyor Belt: -	2 ply x 900mm(36") wide
Drums outside diameter: -	273mm (10.75")
Drum speed Empty: -	105 rpm
Full: -	95 rpm
Conveyor Belt Speed	Empty: - 90m/min(300 ft/min)
	Full: - 85 m/min (280 ft/min)

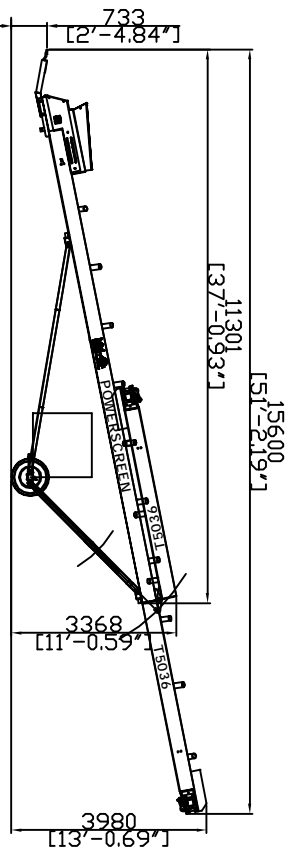
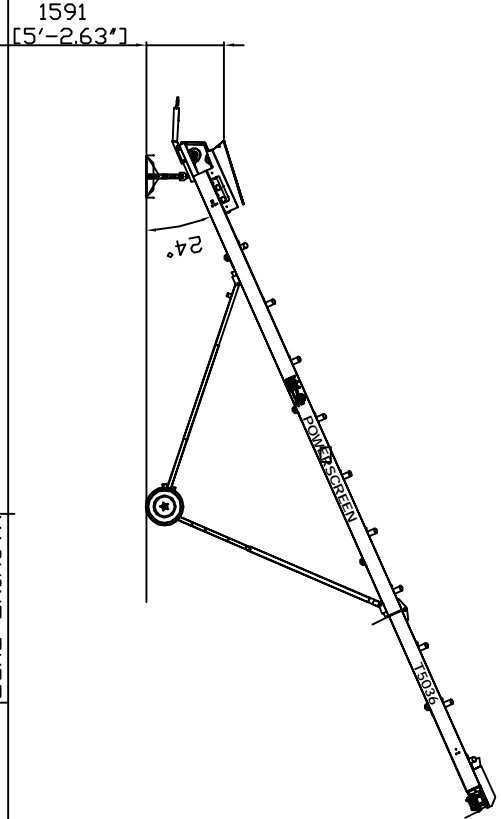
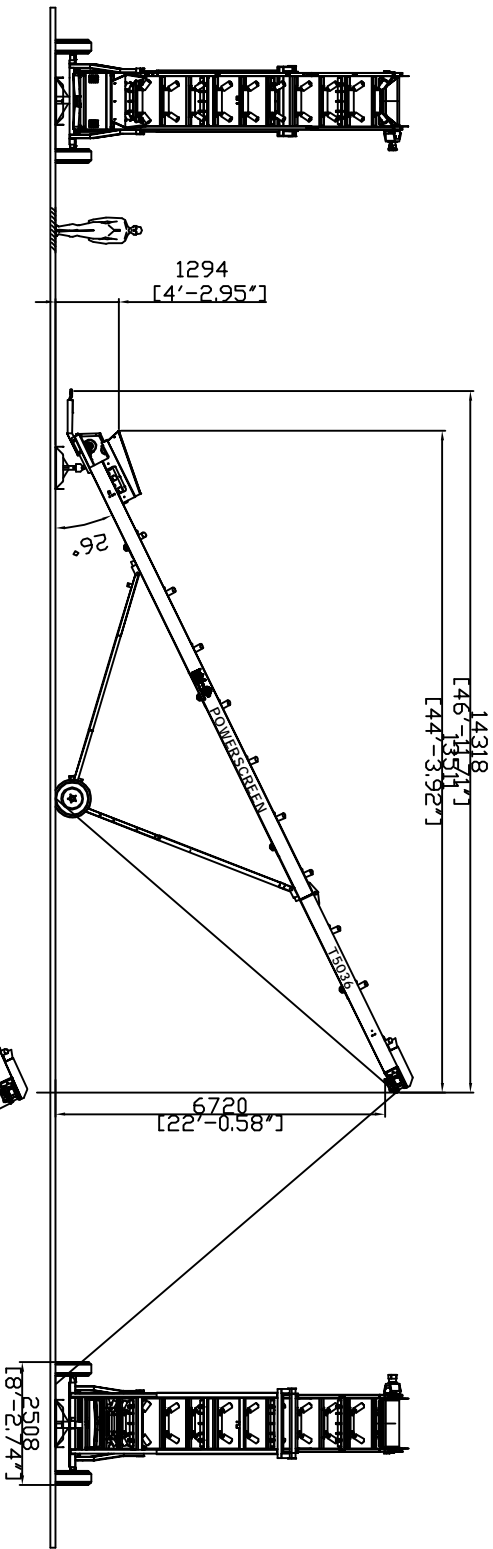
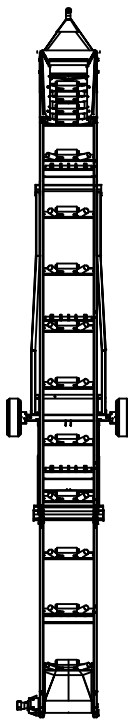
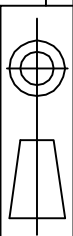

TRANSPORT POSITION

ISSUE		DATE		BY		REVISION	
MACHINE TYPE				TITLE			
T5036				STANDARD			
SCALE		DRN. BY		DATE		CHD. BY	
T5036		T5036		T5036		T5036	
PROJ/ DRAWING NUMBER				SHEET 1 OF 1			
POWERSCREEN A Terex Company POWERSCREEN INTERNATIONAL DISTRIBUTION LTD 207 COALISLAND ROAD, JUNGANNON, CO. TYRONE, N. IRELAND TELE: 01868 740701 FAX: 01868 749569							